

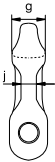

COI

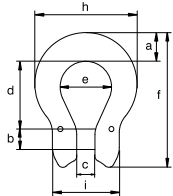

Green Pin® Omega Link S/S-GR5

Grade 5 stainless steel omega link

- **Material:** AISI 316L, grade 5
- **Safety factor:** MBL equals 4 x WLL
- **Finish:** polished
- **Temperature range:** -40 °C up to +200 °C
- **Certification:** 2.1 2.2 3.1 CE IIB
- **Article code:** scan QR code to see article codes
- **Note:** specific load pin available for 5 mm hoist chain on request, which can be combined with GPCO6I



for chain diameter	working load limit	width	diameter pin	width	length inside	width bow	length outside	thickness	width outside	width outside	thickness	weight each
mm	t	a mm	b mm	c mm	d mm	e mm	f mm	g mm	h mm	i mm	j mm	kg
6	0.7	13.5	8	7	25	20	53	13	41	28	6	0.07
7/8	1.2	19.5	9	9	34	24	71	16	55	32	8.5	0.18
10	1.6	19	13	12	40	31	82	17	63	42	11	0.28
13	2.7	25	16	15	51	40	106	20	84	54	13.5	0.64

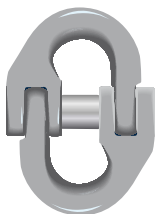

MJI

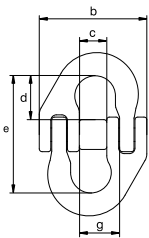

Green Pin® Connecting Link S/S-GR5

Grade 5 stainless steel connecting link

- **Material:** AISI 316L, grade 5
- **Safety factor:** MBL equals 4 x WLL
- **Finish:** polished
- **Temperature range:** -40 °C up to +200 °C
- **Certification:** 2.1 2.2 3.1 CE IIB
- **Article code:** scan QR code to see article codes



for chain diameter	working load limit	diameter	width outside	width inside	length inside	length inside	diameter eye	width inside	weight each
mm	t	a mm	b mm	c mm	d mm	e mm	f mm	g mm	kg
6	0.7	8	42	10.5	20	52	10.5	15	0.09
7/8	1.2	9	53	14	20.5	55	13	19.5	0.15
10	1.6	13	66	18	23.5	64	18	23.5	0.28
13	2.7	18	83	21	32	85	23.5	28	0.64

